

MoveNow Properties



WAKEFIELD OFFICE:

Address: 10 Rishworth Street, Wakefield, WF1 3BY

Web: www.movenowproperties.com

Tel: 01924 249349

Email: info@movenowproperties.com

BARNSELY OFFICE:

Address: 41A Towngate, Mapplewell, S75 6AS

Web: www.movenowproperties.com

Tel: 01226 593477

Email: mapplewell@movenowproperties.com

FOR SALE

Green End Lane, Thornes,

WF2 7AG

2 Bedroom, Mid Terrace

£125,000



Movenowproperties proudly presents this charming 2 bedroom mid terrace home for sale. Impeccably maintained and beautifully presented, this property boasts a spacious kitchen and dining area, perfect for entertaining guests. With a meticulously tended rear garden, it offers a serene retreat just steps away from your doorstep. Don't miss the opportunity to make this your new home!

Accommodation briefly comprises:

Kitchen

Measurements 12' 11" x 9' 1" (3.94m x 2.78m)

Step into culinary delight with this well equipped kitchen offering with a range of wall and base units complemented by wood effect work surfaces. Features include plumbing for a freestanding washing machine, electric oven, gas hob, and integrated fridge freezer. Illuminated by recessed spotlights, this space offers a cosy dining area with a double-glazed window overlooking the rear garden and a UPVC door with frosted glass panel.



Living room

Measurements 13' 1" x 11' 11" (3.99m x 3.64m)

Unwind in style within the spacious confines of the living room. Adorned with a composite entrance door and carpet flooring, it boasts a radiant ambiance enhanced by double-glazed windows. Complete with ceiling coving and a fire surround currently housing a multi-fuel burner, this room exudes warmth and elegance.



Cellar

Measurements 13' 2" x 12' 1" (4.01m x 3.68m)

Discover additional space and utility in the cellar. Accessed via stone stairs, it accommodates gas and electric meters alongside ample storage options, all illuminated by lighting.

Stairs and landing

Ascend the carpeted stairs to the landing, featuring access to bedrooms and the bathroom, ensuring convenience and accessibility throughout.

Bedroom 1

Measurements 13' 0" x 12' 0" (3.97m x 3.65m)

Embrace serenity in the spacious bedroom, enhanced by carpet flooring and a double-glazed window offering picturesque front views, it includes a useful storage cupboard for seamless organisation.



Bedroom 2

Measurements 9' 2" x 6' 10" (2.79m x 2.08m)

Experience comfort in the cosy confines of the second bedroom. Complete with carpet flooring, a radiator, and ample storage space, it offers tranquil rear views through the double-glazed window.



Bathroom

Measurements 6' 5" x 6' 5" 1.95m x 1.95m)

Indulge in modern luxury within the bathroom. Featuring a flush WC, wash basin set in a modern vanity, and a bath with an overhead electric shower, it exudes sophistication. Enhanced by recessed spotlights, tile effect laminate flooring, and a chrome towel heater.



Outside

Escape to the enchanting outdoor oasis, boasting a low-maintenance rear garden with fenced boundaries and rear gate access. Having on street permitted parking.

Experience the epitome of modern living in this meticulously crafted home, where every detail exudes comfort and style.

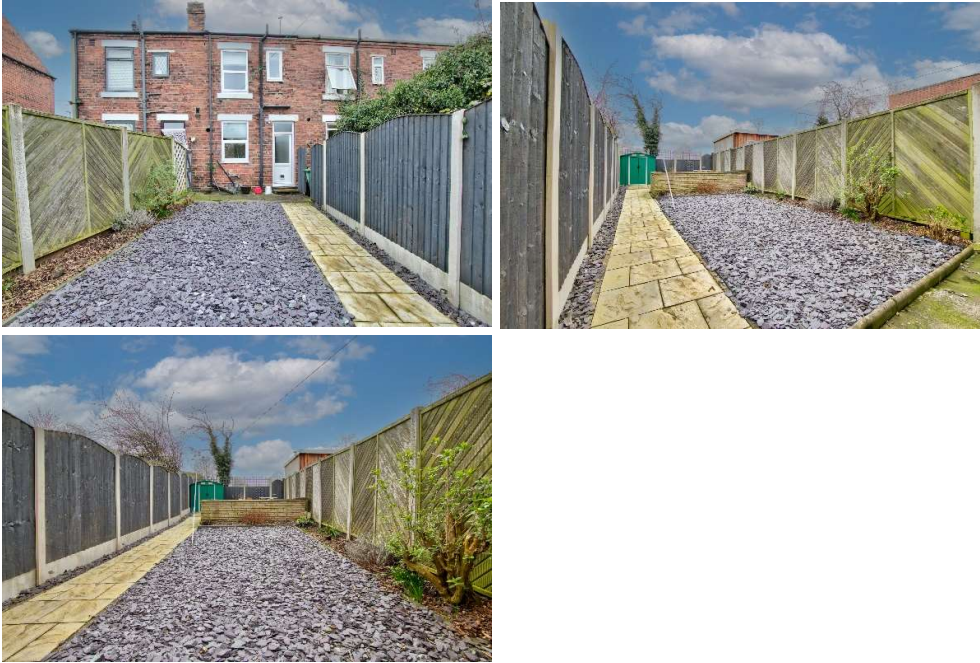

Broadband connection

Fibreoptic

Mobile Coverage

Three

O2

Vodafone

EE

Satellite / Fibre TV Availability

BT

Sky

Virgin

Parking

On street permitted parking with 1 resident permit and 1 visitor permit

Additional Information

There is a pedestrian right of way through the rear for 1 neighbouring property.

Council Tax

Band A

Tenure

Freehold

Floor plans

These floor plans are intended as a rough guide only and are not to be intended as an exact representation and should not be scaled. We cannot confirm the accuracy of the measurements or details of these floor plans.

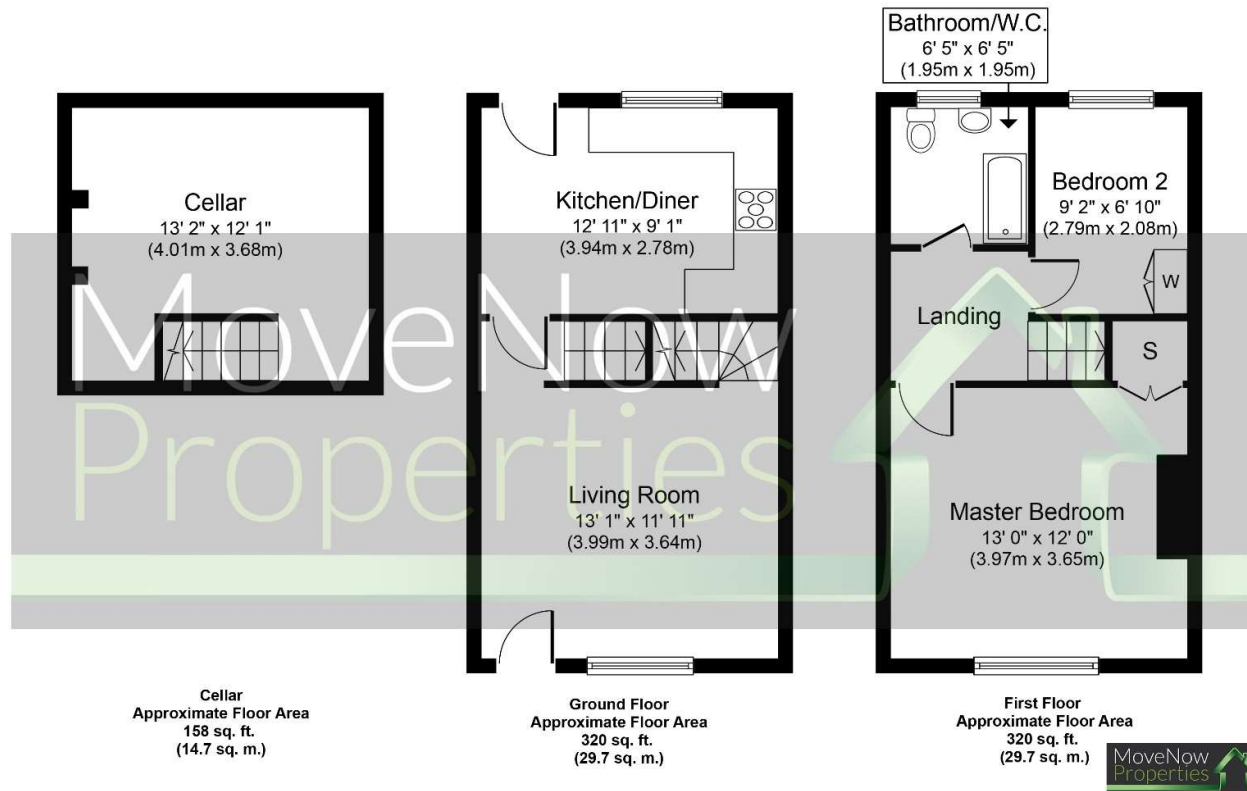

Whilst every attempt has been made to ensure the accuracy of the floor plan contained here, measurements of doors, windows, rooms and any other items are approximate and no responsibility is taken for any error, omission, or mis-statement. The measurements should not be relied upon for valuation, transaction and/or funding purposes. This plan is for illustrative purposes only and should be used as such by any prospective purchaser or tenant. The services, systems and appliances shown have not been tested and no guarantee as to their operability or efficiency can be given.
Copyright V360 Ltd 2024 | www.houseviz.com

EPC

Certificate Number :

Score	Energy rating	Current	Potential
92+	A		
81-91	B		
69-80	C		80
55-68	D		
39-54	E	39	
21-38	F		
1-20	G		

<https://find-energy-certificate.digital.communities.gov.uk/energy-certificate/>

Viewings

For further information or to arrange a viewing please contact our offices directly.

Free valuations

Considering selling or letting your property?

For a free valuation on your property please do not hesitate to contact us.

DISCLAIMER:

The details shown on this website are a general outline for the guidance of intending purchasers, and do not constitute, nor constitute part of, an offer or contract or sales particulars. All descriptions, dimensions, references to condition and other details are given in good faith and are believed to be correct but any intending purchasers should not rely on them as statements or representations of fact but must satisfy themselves by inspection, searches, survey, enquiries or otherwise as to their correctness. We have not been able to test any of the building service installations and recommend that prospective purchasers arrange for a qualified person to check them before entering into any commitment. Further, any reference to, or use of any part of the properties is not a statement that any necessary planning, building regulations or other consent has been obtained. All photographs shown are indicative and cannot be guaranteed to represent the complete interior scheme or items included in the sale. No person in our employment has any authority to make or give any representation or warranty whatsoever in relation to this property.