

MoveNow Properties



WAKEFIELD OFFICE:

Address: 10 Rishworth Street, Wakefield, WF1 3BY

Web: www.movenowproperties.com

Tel: 01924 249349

Email: info@movenowproperties.com

BARNSELY OFFICE:

Address: 41A Towngate, Mapplewell, S75 6AS

Web: www.movenowproperties.com

Tel: 01226 593477

Email: mapplewell@movenowproperties.com

FOR SALE

Hall Cliffe Crescent, Horbury,

WF4 6DG

3 Bedroom, Detached Bungalow

OIEO £225,000



Movenowproperties proudly presents this enchanting three-bedroom detached bungalow, available for sale in the highly desirable area of Horbury. Boasting meticulously maintained gardens both to the front and rear, this property also features a detached garage complete with power and lighting, along with the added convenience of a private gated drive.

- Charming detached bungalow
 - Spacious three bedrooms
- Beautiful gardens in both front and rear
- Secure private gated drive for convenient off-road parking
- Detached garage equipped with power, lighting, and useful storage spaces
 - Ideal sought after location
- Available with vacant possession

Entrance Hall

Step into luxury through the sleek UPVC entrance door, setting the tone for the elegance that awaits within. The warm and inviting ambiance is complemented by the rich wood tile flooring, providing a perfect blend of aesthetics and practicality.

Kitchen

Measurements 8' 9" x 8' 8" (2.66m x 2.65m)

The kitchen features plumbing for a washing machine, ensuring that domestic tasks are effortlessly integrated into your lifestyle. The integrated electric oven with a gas hob caters to both the avid chef and those seeking efficiency in their cooking routine.

As you prepare your meals, the double glazed bay window overlooking the front bathes the kitchen in natural light, creating an atmosphere of warmth and charm.



Living Room

Measurements 15' 4" x 11' 5" (4.67m x 3.47m)

Step into the living room, a haven of comfort and style. The plush carpet flooring underfoot invites you to sink into relaxation as you enter. Natural light floods the room through the double glazed bay window, creating a bright and airy atmosphere that seamlessly blends the indoor and outdoor spaces.



Bedroom 1

Measurements 11' 10" x 9' 10" (3.60m x 3.00m)

Discover tranquility in the double bedroom, a retreat designed for both comfort and style. The soft carpet flooring underfoot creates a warm and inviting atmosphere, making this room a perfect haven for relaxation.



Bedroom 2

Measurements 8' 6" x 10' 5" (2.58m x 3.17m)

Experience the benefits of this thoughtfully appointed space, where the combination of carpet flooring, a radiator, and a rear-facing double glazed window transforms your bedroom into a retreat that seamlessly blends style with functionality.



Bedroom 3

Measurements 7' 3" x 8' 0" (2.21m x 2.43m)

Experience the flexibility and comfort of this well-appointed room, where every detail has been considered to enhance your daily living.



Bathroom

Measurements 6' 8" x 5' 3" (2.02m x 1.59m)

Indulge in the comforts of the bathroom, where thoughtful design meets functionality to create a space of relaxation and rejuvenation. The centrepiece is a luxurious bath with an overhead shower, offering a perfect retreat after a long day. Whether you prefer a leisurely soak or a refreshing shower, this bathroom caters to your every preference.



Outside

The front of the property welcomes you with a private gated drive, providing convenient off-road parking. This is complemented by a well-maintained lawn, adding a touch of greenery and charm to the entrance. As you explore the rear, a garage equipped with power and lighting stands ready to accommodate your needs. Adjacent to it, a washhouse and useful storage space offer additional practicality and functionality. The fenced boundaries ensure privacy, while well-established shrubs contribute to the overall aesthetics of the property.

With access on both sides, the property's layout is designed for ease and convenience. These external features harmonize to enhance the overall appeal of this three-bedroom detached bungalow. It's a home that combines elegance with functionality, creating a unique and inviting living space.



Tenure

Freehold

Floor plans

These floor plans are intended as a rough guide only and are not to be intended as an exact representation and should not be scaled. We cannot confirm the accuracy of the measurements or details of these floor plans.

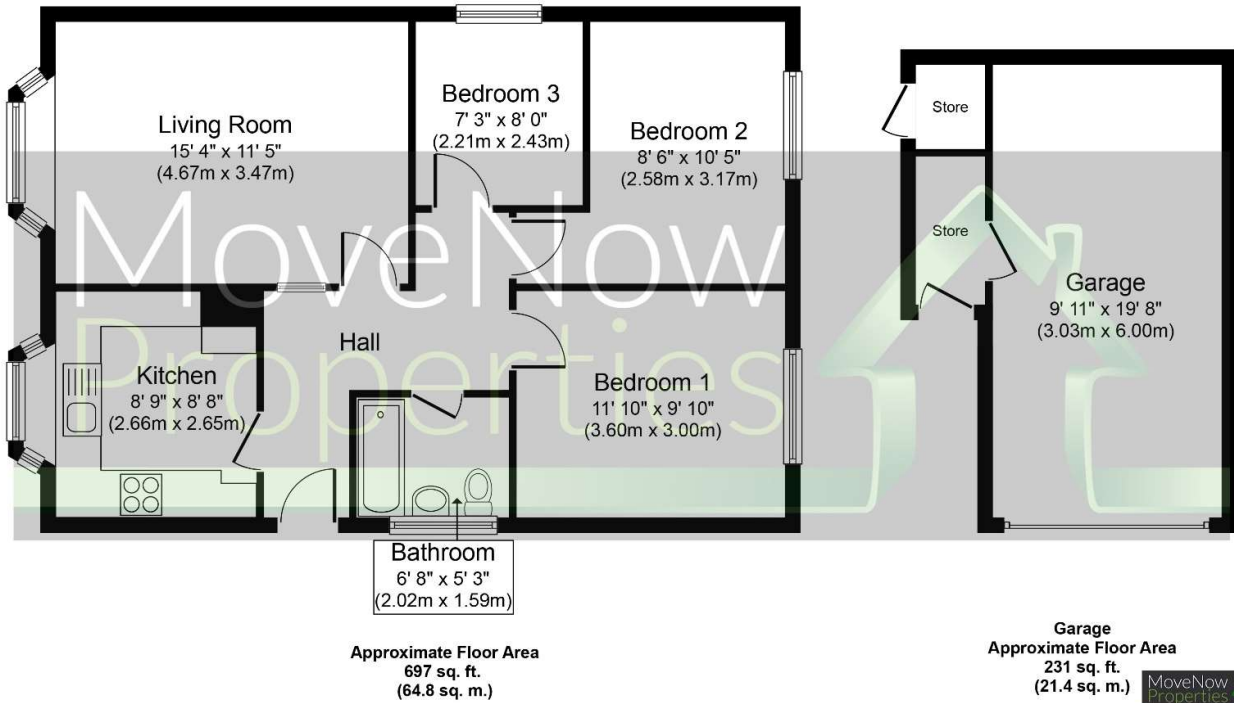

Whilst every attempt has been made to ensure the accuracy of the floor plan contained here, measurements of doors, windows, rooms and any other items are approximate and no responsibility is taken for any error, omission, or mis-statement. The measurements should not be relied upon for valuation, transaction and/or funding purposes. This plan is for illustrative purposes only and should be used as such by any prospective purchaser or tenant. The services, systems and appliances shown have not been tested and no guarantee as to their operability or efficiency can be given.

Copyright V360 Ltd 2024 | www.houseviz.com

Viewings

For further information or to arrange a viewing please contact our offices directly.

Free valuations

Considering selling or letting your property?

For a free valuation on your property please do not hesitate to contact us.

DISCLAIMER:

The details shown on this website are a general outline for the guidance of intending purchasers, and do not constitute, nor constitute part of, an offer or contract or sales particulars. All descriptions, dimensions, references to condition and other details are given in good faith and are believed to be correct but any intending purchasers should not rely on them as statements or representations of fact but must satisfy themselves by inspection, searches, survey, enquiries or otherwise as to their correctness. We have not been able to test any of the building service installations and recommend that prospective purchasers arrange for a qualified person to check them before entering into any commitment. Further, any reference to, or use of any part of the properties is not a statement that any necessary planning, building regulations or other consent has been obtained. All photographs shown are indicative and cannot be guaranteed to represent the complete interior scheme or items included in the sale. No person in our employment has any authority to make or give any representation or warranty whatsoever in relation to this property.