

# MoveNow Properties



WAKEFIELD OFFICE:

Address: 10 Rishworth Street, Wakefield, WF1 3BY

Web: [www.movenowproperties.com](http://www.movenowproperties.com)

Tel: 01924 249349

Email: [info@movenowproperties.com](mailto:info@movenowproperties.com)

BARNSELY OFFICE:

Address: 41A Towngate, Mapplewell, S75 6AS

Web: [www.movenowproperties.com](http://www.movenowproperties.com)

Tel: 01226 593477

Email: [mapplewell@movenowproperties.com](mailto:mapplewell@movenowproperties.com)

**FOR SALE**

**Sandyfield Terrace, Batley,**

**WF17 8LH**

**2 Bedroom, Terrace**

**Guide Price £110,000 - £120,000**



Movenowproperties offer this delightfully well maintained 2 bedroom end terrace. Suitable for investors and first time buyers alike! Must be viewed to fully appreciate.

- 2 bedrooms
- Well maintained
- Ideal for first time buyers
- Ideal for potential investors
- Parking operated by first come first served basis
- Four piece bathroom suite
- Must be viewed to be appreciated

Accommodation briefly comprises:

### **Entrance Hallway**

Freshly painted, attractive hardwood entrance door leading to hallway, laminate flooring, stairs to first floor and doors leading to living room and kitchen.



### **Living Room**

**Measurements: 13' 2" x 12' 3" (4.01m x 3.74m)**

Cosy living space with laminate flooring, neutrally decorated, hardwood doors leading to small outside space and double glazed window with fitted blinds, radiator and wall & ceiling lights.



## Kitchen

**Measurements: 12' 8" x 6' 8" (3.86m x 2.04m)**

A variety of wall and base units with complementary worksurfaces, sink and drainer with mixer tap, washing machine, tumble dryer, undercounter fridge and freezer, electric oven and hob with extractor above, double glazed window with fitted blind, radiator, and useful understairs storage cupboard.



## Stairs & Landing

Carpet flooring, doors leading to separate rooms, neutrally decorated, double glazed window to side aspect, radiator and storage cupboard.



## Bedroom 1

**Measurements: 13' 3" x 8' 4" (4.04m x 2.54m)**

Double bedroom with carpet flooring, double glazed window to rear with fitted blind, fitted wardrobe space, radiator, neutral decoration and dado rail.



## Bedroom 2

**Measurements: 10' 2" x 5' 10" (3.10m x 1.78m)**

Single bedroom with neutral decoration, double glazed window with fitted blind to front, radiator and carpet flooring.



## Bathroom

**Measurements: 9' 6" x 6' 6" (2.89m x 1.98m)**

Comprising of a 4 piece suite in white having low flush WC, pedestal wash basin, bath, corner shower cubicle, chrome towel radiator, vinyl flooring, part tiling to walls, storage cupboard housing combi boiler and frosted double glazed window with fitted blind.



## Outside

To the front and rear of the property are small low maintenance pebbled / patio areas. There is parking available which is operated on a first come first served basis.



## Boiler

Combi boiler Ideal Esprit ECO 30

## Broadband

Basic 16 Mbps

Superfast 56 Mbps

Ultrafast 1000 Mbps

### Mobile Coverage

Three  
O2  
Vodafone

### Satellite / Fibre TV Availability

BT  
Sky  
Virgin

### Parking

Courtyard

### Council Tax

Band B

### Tenure

Freehold

### EPC

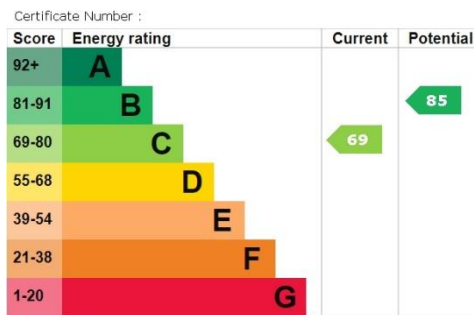

<https://find-energy-certificate.digital.communities.gov.uk/energy-certificates/>

### Viewings

For further information or to arrange a viewing please contact our office on 01924 249349.

### Free valuations

Considering selling or letting your property?

For a free valuation on your property please do not hesitate to contact us:

01924 249349

info@movenowproperties.com

www.movenowproperties.com

## Floor plans

These floor plans are intended as a rough guide only and are not to be intended as an exact representation and should not be scaled. We cannot confirm the accuracy of the measurements or details of these floor plans.

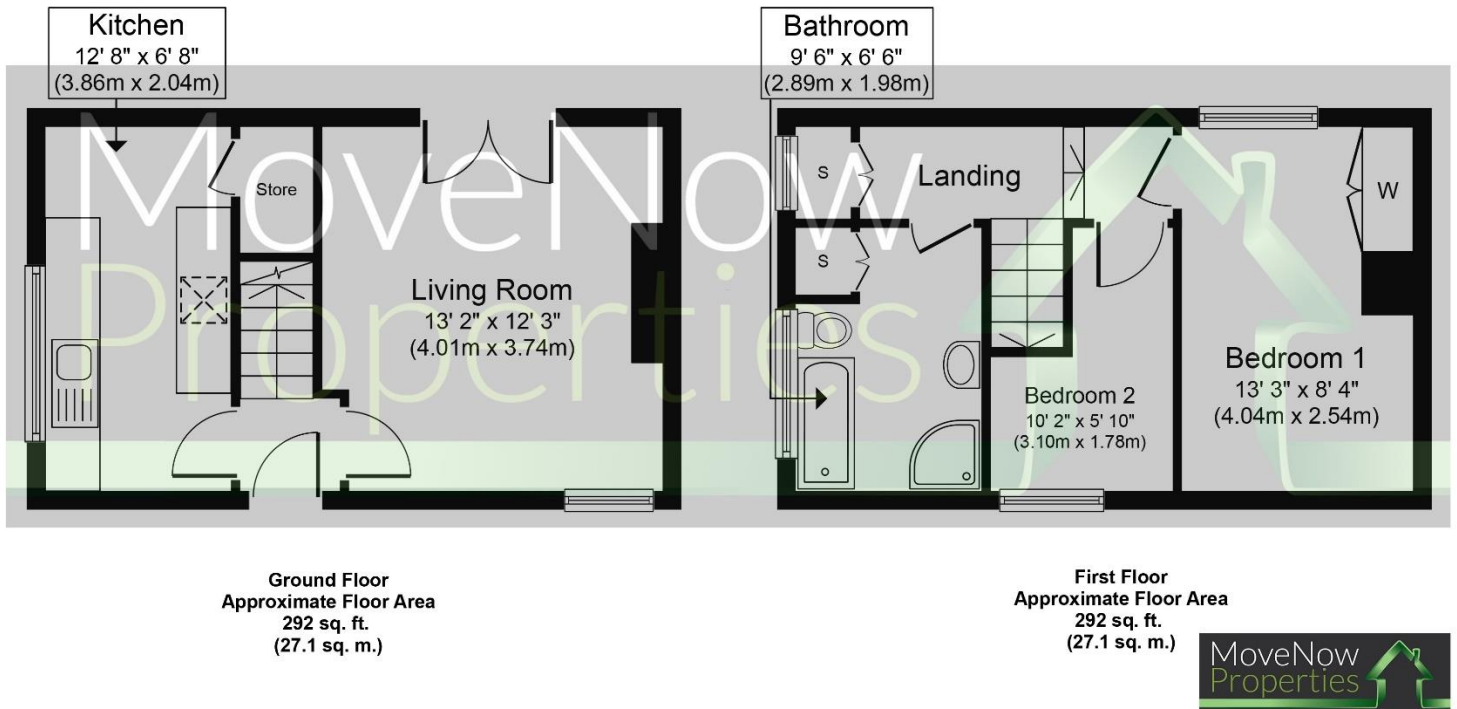

Whilst every attempt has been made to ensure the accuracy of the floor plan contained here, measurements of doors, windows, rooms and any other items are approximate and no responsibility is taken for any error, omission, or mis-statement. The measurements should not be relied upon for valuation, transaction and/or funding purposes. This plan is for illustrative purposes only and should be used as such by any prospective purchaser or tenant.

The services, systems and appliances shown have not been tested and no guarantee as to their operability or efficiency can be given.

Copyright V360 Ltd 2024 | [www.houseviz.com](http://www.houseviz.com)

## DISCLAIMER:

The details shown on this website are a general outline for the guidance of intending purchasers, and do not constitute, nor constitute part of, an offer or contract or sales particulars. All descriptions, dimensions, references to condition and other details are given in good faith and are believed to be correct but any intending purchasers should not rely on them as statements or representations of fact but must satisfy themselves by inspection, searches, survey, enquiries or otherwise as to their correctness. We have not been able to test any of the building service installations and recommend that prospective purchasers arrange for a qualified person to check them before entering into any commitment. Further, any reference to, or use of any part of the properties is not a statement that any necessary planning, building regulations or other consent has been obtained. All photographs shown are indicative and cannot be guaranteed to represent the complete interior scheme or items included in the sale. No person in our employment has any authority to make or give any representation or warranty whatsoever in relation to this property.