

# MoveNow Properties



**WAKEFIELD OFFICE:**

**Address:** 10 Rishworth Street, Wakefield, WF1 3BY

**Web:** [www.movenowproperties.com](http://www.movenowproperties.com)

**Tel:** 01924 249349

**Email:** [info@movenowproperties.com](mailto:info@movenowproperties.com)

**BARNSELY OFFICE:**

**Address:** 41A Towngate, Mapplewell, S75 6AS

**Web:** [www.movenowproperties.com](http://www.movenowproperties.com)

**Tel:** 01226 593477

**Email:** [mapplewell@movenowproperties.com](mailto:mapplewell@movenowproperties.com)

**FOR SALE**

Wordsworth Grove, Stanley,

Wakefield, WF3 4JL

**2 Bed, Semi Detached**

**£170,000**



Movenowproperties are delighted to offer this well presented 2 Bedroom Semi-detached property for sale. In the heart of Stanley, benefitting from 2 double bedrooms and a conservatory. This property must be viewed to be fully appreciated.

Accommodation briefly comprises:

Door leading to entrance porch and door to lounge.

### Open Living / Kitchen Area

**Measurements: 26' 1" x 12' 2" (7.95m x 3.71m)**

Open plan living space with double glazed windows to front, white walls with a red feature wall with gas fire and newly fitted double radiator and spotlights.



### Kitchen

The kitchen has a range of wall and base units, with the benefit of a breakfast bar, work surfaces, sink and drainer, electric oven & hob with extractor hood above, vinyl flooring, space for washing machine, space for fridge / freezer, double glazed window to rear and door to conservatory.



### Conservatory

**Measurements: 15' 7" x 10' 6" (4.76m x 3.19m)**

Spacious conservatory, ideal for relaxing with double glazed windows, neutral decoration, UPVC French door and wood effect laminate flooring.



### Stairs/Landing

Stairway leading to landing space with doors to separate rooms.

### Bedroom 1

**Measurements: 11' 1" x 10' 6" (3.39m x 3.19m)**

Double bedroom with double glazed window to front elevation, carpet flooring, fitted wardrobe, storage cupboard and radiator.



### Bedroom 2

**Measurements: 11' 3" x 8' 2" (3.42m x 2.50m)**

A spacious second double bedroom with double glazed windows to rear, carpet flooring and radiator.



### Bathroom

**Measurements 6' 1" x 5' 0" (1.86m x 1.53m)**

Comprising of a 3 piece suite having bath with overhead mains shower, low flush WC, pedestal wash basin, radiator, frosted double glazed window and tiled walls.



### Outside

To the front of the property is a small lawned area.

To the side of the property is a driveway offering off street parking.

To the rear is a spacious enclosed garden with side access, patio area and decked area.



## Local Area

The property is located within the popular area of Stanley, benefiting from being in the catchment area of Stanley St Peters School with various amenities and motorway links nearby.

## Tenure

Freehold

## EPC

Certificate Number :

Score	Energy rating	Current	Potential
92+	A		
81-91	B		89
69-80	C		
55-68	D	67	
39-54	E		
21-38	F		
1-20	G		

<https://find-energy-certificate.digital.communities.gov.uk/energy-certificate/>

## Viewings

For further information or to arrange a viewing please contact our office on 01924 249349.

## Free valuations

Considering selling or letting your property?

For a free valuation on your property please do not hesitate to contact us [Movenowproperties.com](http://Movenowproperties.com) 01924 249349 / [info@movenowproperties.com](mailto:info@movenowproperties.com)

## DISCLAIMER:

The details shown on this website are a general outline for the guidance of intending purchasers, and do not constitute, nor constitute part of, an offer or contract or sales particulars. All descriptions, dimensions, references to condition and other details are given in good faith and are believed to be correct but any intending purchasers should not rely on them as statements or representations of fact but must satisfy themselves by inspection, searches, survey, enquiries or otherwise as to their correctness. We have not been able to test any of the building service installations and recommend that prospective purchasers arrange for a qualified person to check them before entering into any commitment. Further, any reference to, or use of any part of the properties is not a statement that any necessary planning, building regulations or other consent has been obtained. All photographs shown are indicative and cannot be guaranteed to represent the complete interior scheme or items included in the sale. No person in our employment has any authority to make or give any representation or warranty whatsoever in relation to this property.

## Floor plans

These floor plans are intended as a rough guide only and are not to be intended as an exact representation and should not be scaled. We cannot confirm the accuracy of the measurements or details of these floor plans.

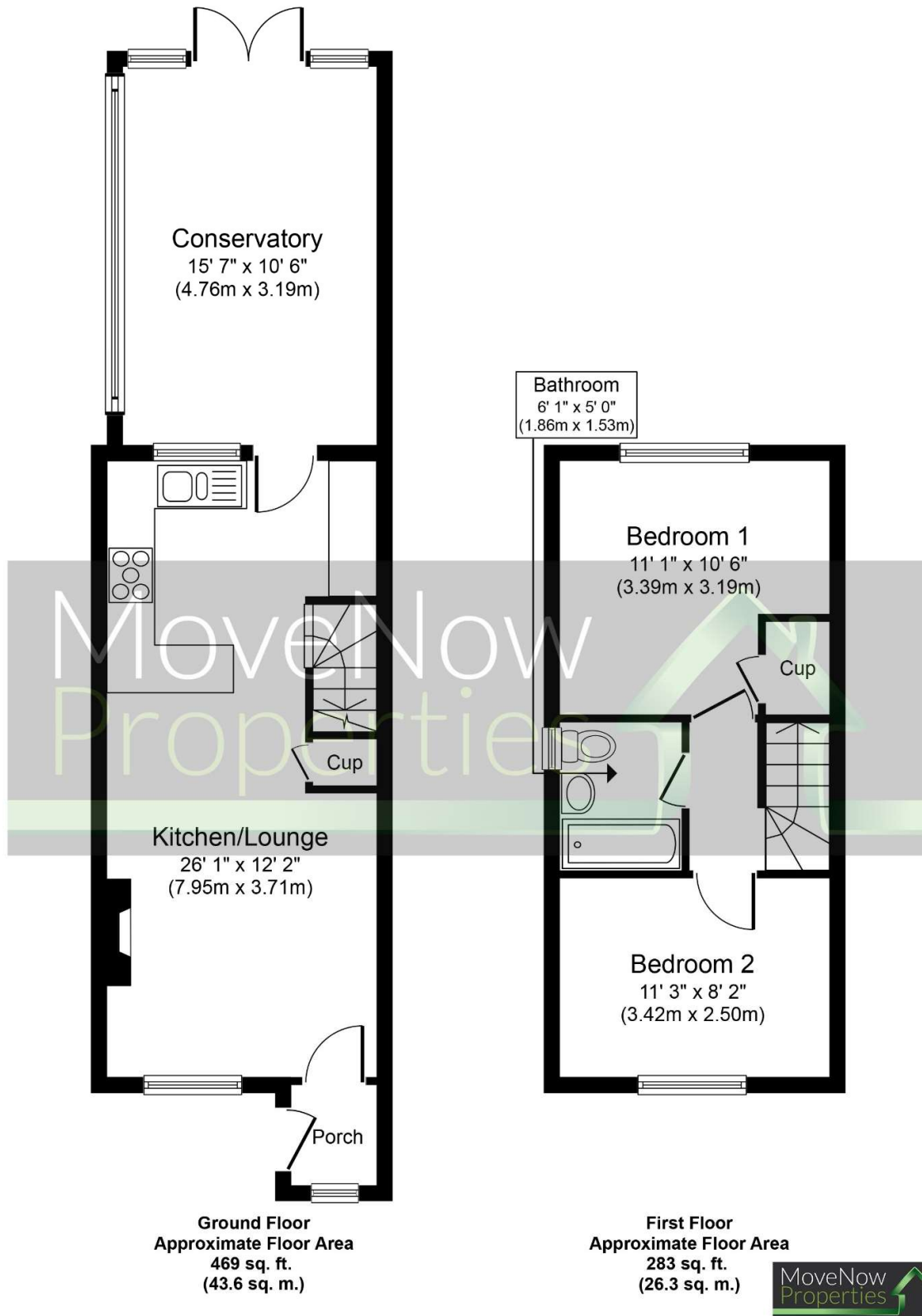

Whilst every attempt has been made to ensure the accuracy of the floor plan contained here, measurements of doors, windows, rooms and any other items are approximate and no responsibility is taken for any error, omission, or mis-statement. The measurements should not be relied upon for valuation, transaction and/or funding purposes. This plan is for illustrative purposes only and should be used as such by any prospective purchaser or tenant. The services, systems and appliances shown have not been tested and no guarantee as to their operability or efficiency can be given.