

Move Now Sales



10 Rishworth Street, Wakefield, WF1 3BY

Web: www.movenowproperties.com

Tel: 01924 249349

Email: info@movenowproperties.com

FOR SALE

Regent Street, Wakefield,

WF1 5HW

3 Bedroom, Mid Terrace

£140,000



Movenowproperties are pleased to offer this well presented 3 bedroom terrace property for sale. Having 2 large reception rooms, kitchen in rear extension, cellar, enclosed low maintenance rear patio, 3 good sized bedrooms and bathroom. Available with no chain.

Living Room

Measurements: 13' 5" x 12' 8" (4.10m x 3.87m)

A well presented living area with carpet flooring, radiator, double glazed window overlooking the front and electric fire with attractive surround.



Dining Room

Measurements: 12' 9" x 12' 8" (3.88m x 3.87m)

A spacious second reception room with carpet flooring, radiator, modern serving hatch to kitchen and chimney breast with opening offering feature lighting.



Kitchen

Measurements: 9' 8" x 7' 11" (2.94m x 2.41m)

Located at the rear of the property this extension provide a kitchen area offering a range of wall and base units, complementary work surfaces, tiled upstand, integrated oven, 4 ring electric hob and cooker hood above. Stainless steel sink with drainer and mixer tap, radiator, double glazed window and UPVC glazed door opening to the enclosed rear garden.



Cellar

Measurements: 12' 10" x 11' 0" (3.90m x 3.35m)

Currently housing gas and electric meters, lighting and cold slab.

Stairs & Landing to first floor

Having carpet flooring, hand rail and doors to bedrooms and bathroom.

Bedroom 1

Measurements: 12' 8" x 10' 11" (3.86m x 3.32m)

A spacious bedroom with carpet flooring, radiator and double glazed window overlooking the front.



Bedroom 2

Measurements: 9' 9" x 7' 11" (2.98m x 2.41m)

Another good sized bedroom with carpet flooring, radiator, double glazed window overlooking the rear and storage cupboard housing combi boiler.



Bathroom

Measurements: 9' 8" x 4' 5" (2.95m x 1.34m)

Comprising of a white 3 piece suite, bath with overhead shower, pedestal wash basin, low flush wc and frosted double glazed window overlooking the rear.



Stairs and landing to second floor.

Having fire safety door from first floor landing opening to stairs leading to second floor. Carpet flooring and hand rail.

Bedroom 3

Measurements: 16' 6" x 12' 7" (5.02m x 3.83m)

Another double bedroom with carpet flooring, Velux window, radiator and recessed spot lights.



Outside

To the front of the property is on street parking and a pleasant buffer garden.

To the rear of the property is a low maintenance enclosed rear garden. Having patio flags, brick and fenced boundaries and gate leading to rear.



Tenure

Freehold

EPC

Certificate Number :

Score	Energy rating	Current	Potential
92+	A		
81-91	B		82
69-80	C		
55-68	D	60	
39-54	E		
21-38	F		
1-20	G		

<https://find-energy-certificate.digital.communities.gov.uk/energy-certificate/>

Floor plans

These floor plans are intended as a rough guide only and are not to be intended as an exact representation and should not be scaled. We cannot confirm the accuracy of the measurements or details of these floor plans.

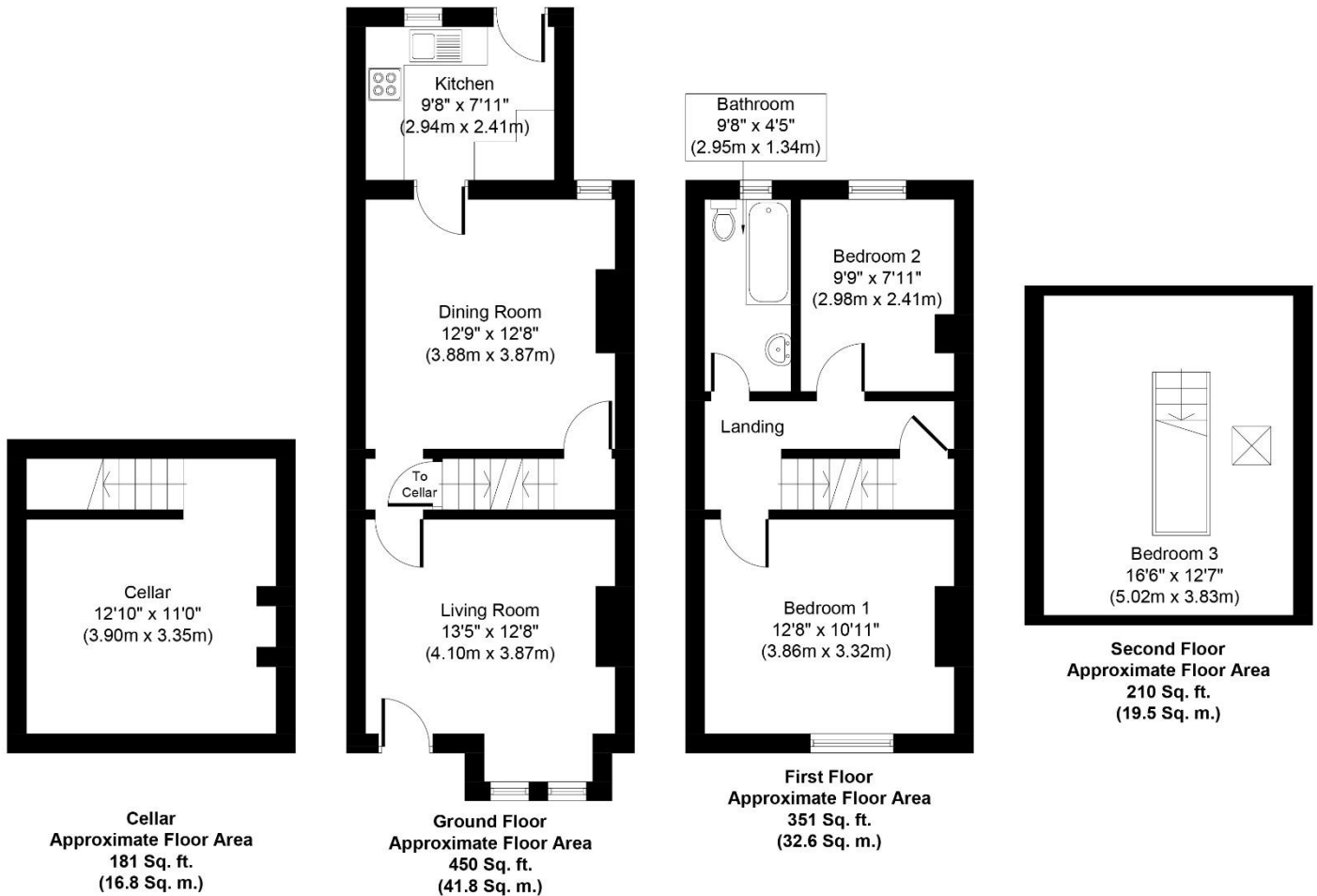

Whilst every attempt has been made to ensure the accuracy of the floor plan contained here, measurements of doors, windows, rooms and any other items are approximate and no responsibility is taken for any error, omission, or mis-statement. The measurements should not be relied upon for valuation, transaction and/or funding purposes. This plan is for illustrative purposes only and should be used as such by any prospective purchaser or tenant. The services, systems and appliances shown have not been tested and no guarantee as to their operability or efficiency can be given.

Copyright V360 Ltd 2022 | www.houseviz.com

Viewings

For further information or to arrange a viewing please contact our office on 01924 249349.

Free valuations

Considering selling or letting your property?

For a free valuation on your property please do not hesitate to contact us Movenowproperties.com 01924 249349 / info@movenowproperties.com

DISCLAIMER:

The details shown on this website are a general outline for the guidance of intending purchasers, and do not constitute, nor constitute part of, an offer or contract or sales particulars. All descriptions, dimensions, references to condition and other details are given in good faith and are believed to be correct but any intending purchasers should not rely on them as statements or representations of fact but must satisfy themselves by inspection, searches, survey, enquiries or otherwise as to their correctness. We have not been able to test any of the building service installations and recommend that prospective purchasers arrange for a qualified person to check them before entering into any commitment. Further, any reference to, or use of any part of the properties is not a statement that any necessary planning, building regulations or other consent has been obtained. All photographs shown are indicative and cannot be guaranteed to represent the complete interior scheme or items included in the sale. No person in our employment has any authority to make or give any representation or warranty whatsoever in relation to this property.